

J:\16\030791003.dwg
10-24-03

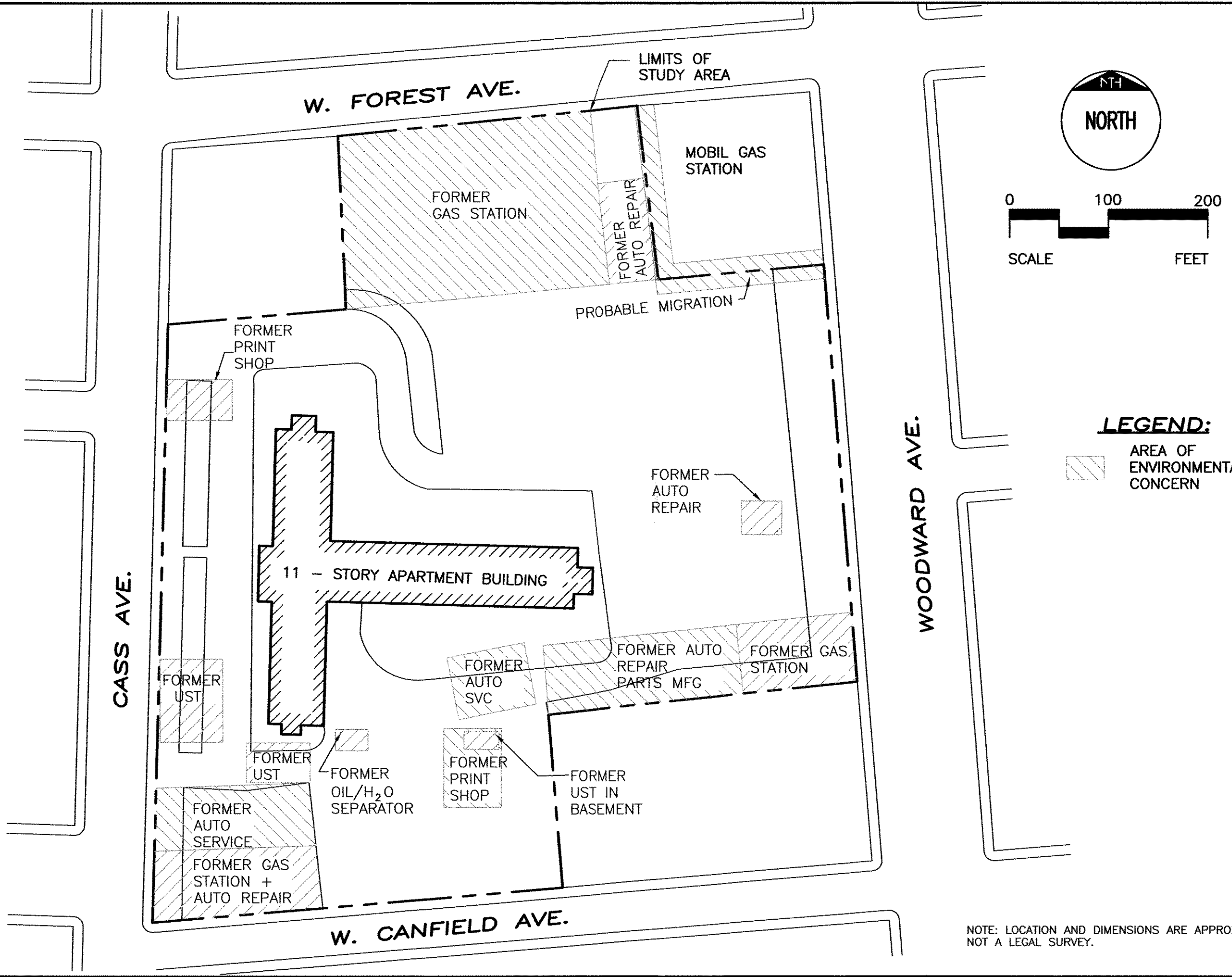

NTH Consultants, Ltd.
Professional Engineering & Environmental Services
Farmington Hills Detroit Exton Grand Rapids Lansing

PROJECT NO.	16-030791-00
SCALE:	AS SHOWN
DRAWN BY:	JD
CHECKED BY:	JPS

**SITE PLAN SHOWING
AREAS OF ENVIRONMENTAL CONCERN**

WSU UNIVERSITY TOWER PROPERTY
4500 CASS AVENUE
DETROIT, MI

DATE:
10-24-03

SHEET
1 OF 1

PLATE NO:

3